

GKA-150 Compact Monitor Bracket (Tilt & Swivel)

Features

- Monitor bracket made from aluminium alloy which adheres to the 75 x 75 mm VESA Standard
- Height adjustable
- Ball-shaped holding portion allows adjustment to any desired angle (loosen the screw and adjust)
- On a made-to-order basis, the central pole can be supplied in different lengths

Notes

- Monitor mount is used for moving and adjusting monitor position
- Do not apply load on display when using
- Durability varies depending on operating environment and frequency

Parts Included

- Hex key (for fixing the mounting base)

Recommended Screws

- Tapping screw 4.5 or M4 screw

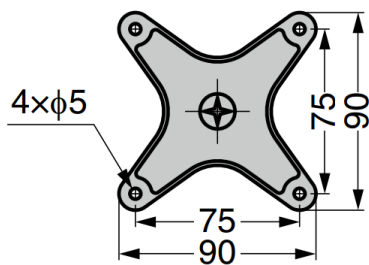
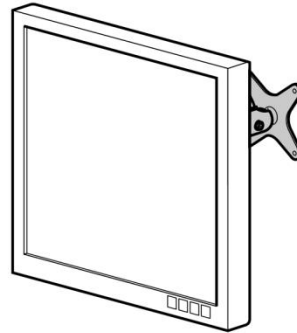

Mounting plate

(Direction of notch ☆)

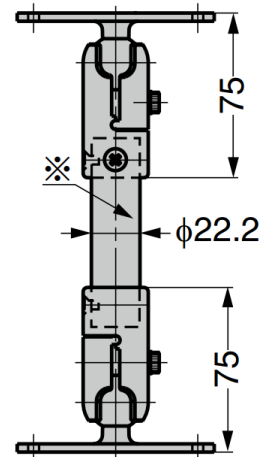
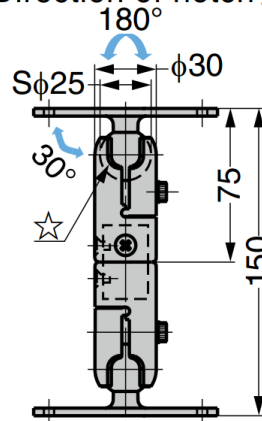

※ Custom pole lengths available on made-to-order basis

Part No.	Material	Finish/Colour	Load Capacity (per piece)	
GKA-150	Aluminium Alloy	Silver Enamel Finish	4.4 N.m	0.45 kgf.m